

ARCHITECTURAL SOLUTIONS



The Project:

THEATER ADDITION @ CLARK HIGH SCHOOL

CLIENT: Clark County School District

LOCATION: Las Vegas, Nevada

ARCHITECT: Gary Guy Wilson, A.I.A.
GGWArchitects²

LAYOUT: Lobby, Public Restrooms,
Ticket Booth, Concession
Area, Theater Seating, Stage
Drama Classroom, Dressing
Rooms, Storage, Control
Room, Building Support
Areas

SPECIALTIES: Stage Rigging and Lighting,
Audio-Visual Systems

AREA: Stage 2,700 s.f. Theater
4,750 s.f., Drama Classroom
1,170 s.f. Prop Construction
1,205 s.f. and Second Floor
Control Room 503 s.f.

TOTAL: 15,348 s.f.

ZONING: R-E

ACRES: 39.90 Total School Property

The Issues:

To create a new Theater for the Clark Senior High School with a minimum seating capacity of 450 and to site it within the existing school property without adversely impacting the overall site and its content.

The challenge was to design the theater in such a manner that the new building would enhance the overall appearance of the school complex and yet be compatible with the existing materials and colors. New security issues were also a major concern.

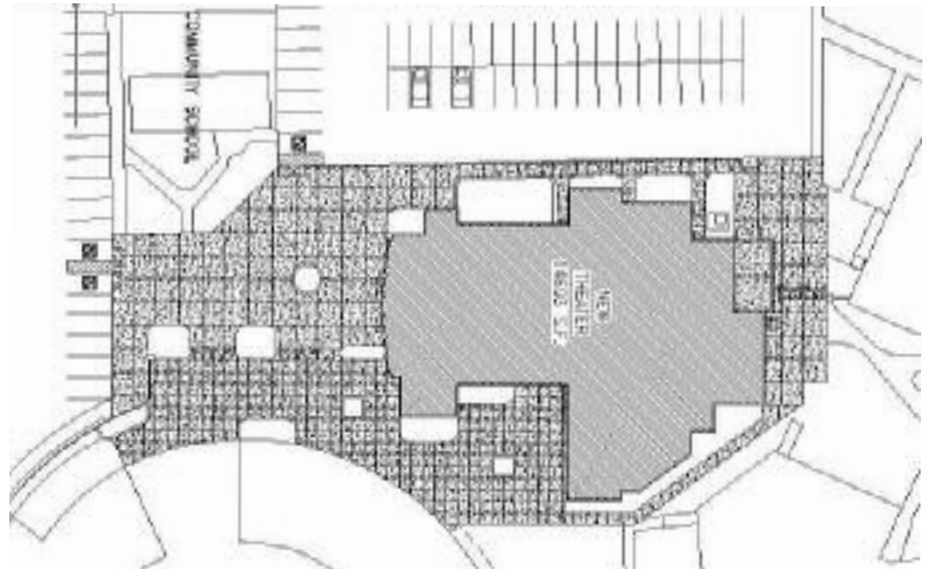

architecture / engineering / site
GARY GUY WILSON
7625 S. Dean Martin Dr. #100, Las Vegas, NV 89139

planning / interior design
STUDIOS...
(702) 876-0668

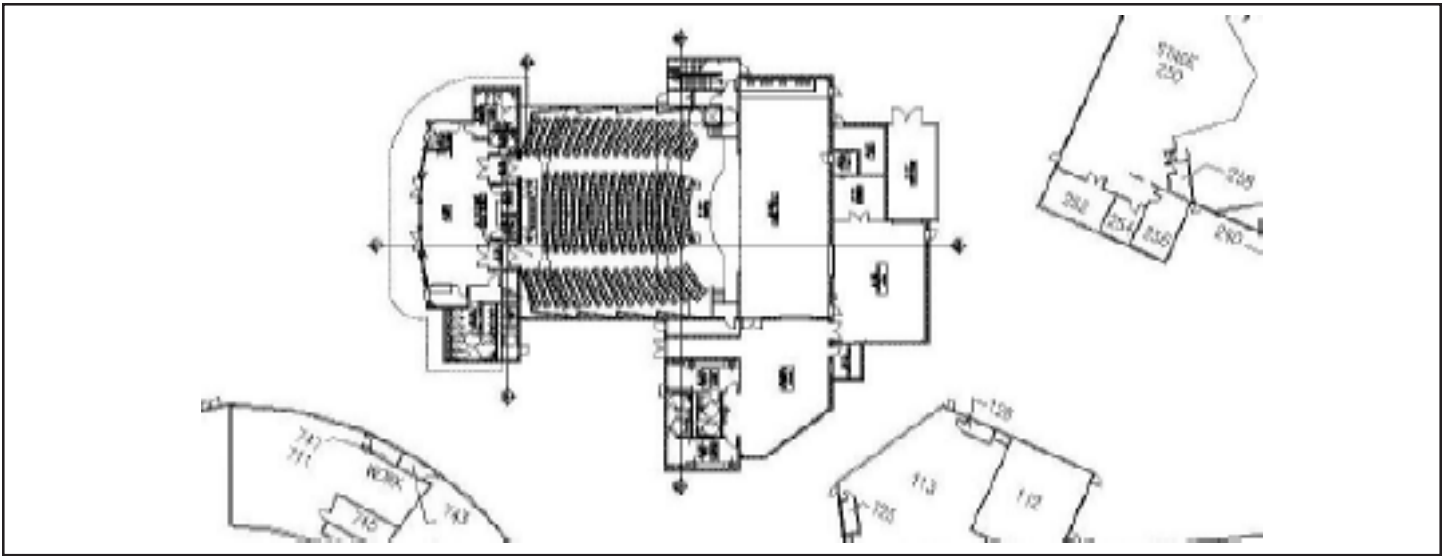

The Answers:

The new Clark High School Theater design will accommodate 454 seats in a manner that will allow students and families to comfortably view various theater programs and functions. The seating area is sloped to assure that each individual has a good view of the stage area.

The Lobby provides space to support the egress and ingress of the theater seating area and allows for access to the public restrooms. Performers have excellent space to dress and prepare for performances in the convenient backstage areas, as well as, a large classroom area for instruction. Supporting areas for prop construction and prop storage are designed for easy movement of props onto the stage.

Catwalks, placed above the ceiling, allow the technicians direct access

to stage lighting from a 2nd level control room and stairs near the stage. Also included is a sophisticated Audio Visual system, enhancing the overall quality of sound and film presentation within the theater. Interior design elements have been introduced for optimal performance of mechanical equipment and containment of noise within the theater, so that the new complex has minimum impact on surrounding properties.

Other Solutions:

- Aux. Gym & Classroom Additions
- New Stadium Bleachers
- Facility-Assessment
- Office & Classroom Additions @ Roy Martin Middle School
- Office & Classroom Additions @ K.O. Knudson Middle School



One of the GGW Architects² Project Teams: (Left to Right) Les. W. Travis, R.A., Steven M. Moore, Gary Guy Wilson, A.I.A., President.

The Advantage:

GGW Architects² emerged as a separate "Education Studio" in October, 2002 from GARY GUY WILSON, AIA, ARCHITECTS STUDIO, serving clients since 1969. The new studio is the result of a growing need for a skilled, specialized Architectural Team delivering creative, relevant, practical and timely solutions for Educational Facilities.

Our Goal: "Education...the Complete Focus." **Our Mission:** "Relevant Design Service to Education." Both enable your budget and schedule needs to be met. Listening and remaining flexible to those needs brings an unmatched kind of service to every phase of the project. **We aren't satisfied until you are satisfied.**

For more information, contact:

- Les W. Travis Architect
- Gary Guy Wilson Architect @ (702) 876-0668.



Southwest Exterior Facade of the Auxiliary Gymnasium @ Clark High School, Las Vegas, Nevada